

永磁直行星齿轮电机 (内齿圈材质: 金属和粉末金属)
 PM DC Planetary Gear Motor (Ring Gear Material: Metal and Powder Metal)

36JXE30K/36ZY50 $\phi 36$ 行星减速器, 允许转矩范围: 0.3N.m~3.0N.m
 36mm Planetary Gearbox
 Permissible Load Range: 0.3N.m~3.0N.m

可在两种材料的内齿圈中进行选择: 粉末金属 (型号36JXF30K), 金属 (型号36JXE30K)
 Ring gear can be selected within the two materials: Powder metal (Type:36JXF30K), Metal (Type:36JXE30K)

● 外形和安装尺寸 Dimensions

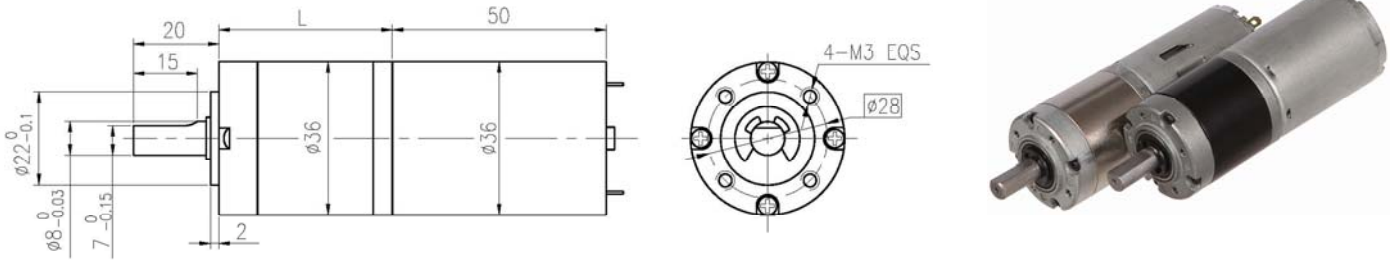

● 电动机主要技术参数 Motor Technical Data

电机型号 TYPE	额定电压 Rated voltage VDC	空载转速 No-load speed r/min	空载电流 No-load current mA	额定转速 Rated speed r/min	额定转矩 Rated torque mN.m	输出功率 Output power W	额定电流 Rated current A	堵转转矩 Stall torque mN.m	堵转电流 Stall current A
36ZY50-2436	24	3600	100	3000	11	3.4	0.40	58	1.7
36ZY50-2442	24	4200	120	3450	12	4.2	0.43	52	1.6

● 齿轮减速电机主要技术参数 Gear Motor Technical Data

配置 36ZY50-2436 直流电机 (36ZY50-2436 DC Motor)

减速比 Reduction ratio	3.7	5.2	14	19	27	51	71	100	139	189	264	369	516
减速级数 Number of gear trains	1	1	2	2	2	3	3	3	3	4	4	4	4
减速器长度(L) Length(L) mm	26.5	26.5	33.6	33.6	33.6	40.5	40.5	40.5	40.5	47.4	47.4	47.4	47.4
空载转速 No-load speed r/min	970	695	257	189	133	71	51	36	26	19	14	9.8	7.0
额定转速 Rated speed r/min	809	579	214	158	111	59	42	30	22	16	11	8.1	5.8
额定转矩 Rated torque N.m	0.037	0.051	0.12	0.17	0.24	0.41	0.57	0.80	1.1	1.4	1.9	2.6	3
最大瞬时允许负载 Max. permissible load in a short time N.m	1.0	1.0	3.5	3.5	3.5	7.5	7.5	7.5	7.5	9	9	9	9

配置 36ZY50-2442 直流电机 (36ZY50-2442 DC Motor)

减速比 Reduction ratio	3.7	5.2	14	19	27	51	71	100	139	189	264	369	516
减速级数 Number of gear trains	1	1	2	2	2	3	3	3	3	4	4	4	4
减速器长度(L) Length(L) mm	26.5	26.5	33.6	33.6	33.6	40.5	40.5	40.5	40.5	47.4	47.4	47.4	47.4
空载转速 No-load speed r/min	1132	811	300	221	156	82	59	42	30	22	16	11	8.1
额定转速 Rated speed r/min	930	666	246	182	128	68	49	35	25	18	13	9.3	6.7
额定转矩 Rated torque N.m	0.040	0.056	0.14	0.18	0.26	0.45	0.62	0.88	1.2	1.5	2.1	2.9	3
最大瞬时允许负载 Max. permissible load in a short time N.m	1.0	1.0	3.5	3.5	3.5	7.5	7.5	7.5	7.5	9	9	9	9

● 电动机特性图 Motor Characteristic Figure

